

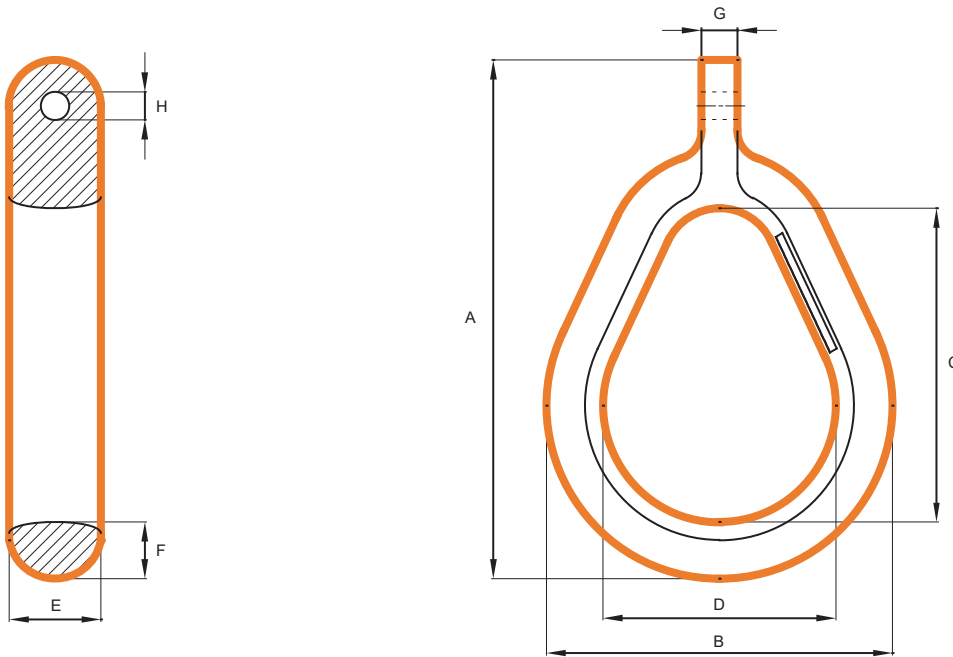

Permanent – Chain Chasers

For Long Term Mooring applications



Type	SWL	Proof Load	Weight	A	B	C	D	E	F	G	H
100	130	250	1315	1582	1112	845	705	330	203	130	99
102	100	250	1084	1657	1143	991	762	305	191	124	86
106	130	250	1443	1702	1168	991	762	381	203	130	99
110	130	250	1433	1867	1245	1130	838	330	203	130	99
112	130	250	2064	2210	1385	1043	952	356	260	130	99
4110	250	400	2420	2040	1361	1095	804	406	280	178	144

Weight unit is Kilograms. All measurements in mm. Measurements, weights, and drawings, are based on industry standards. Deviation margins need to be taken in mind, this is your own responsibility and not from Castle Hills AS.